

frost-proof pavement (with **FK-5-UFO** cross spacers)  
crushed stone bedding min. 3,0 cm

- **DIADEM® DiaDrain-25H-DP** drainage board filled
- **DIADEM® VLU-300** protection geotextile (root-resistant) waterproofing membrane
- thermal insulation
- **DIADEM® FLW-400** vapour control layer
- additional layers

■ **TRK-20-AL** gravel guard

■ **TRF-40-FF** terrace grille

■ **FK-5-UFO**  
cross spacer

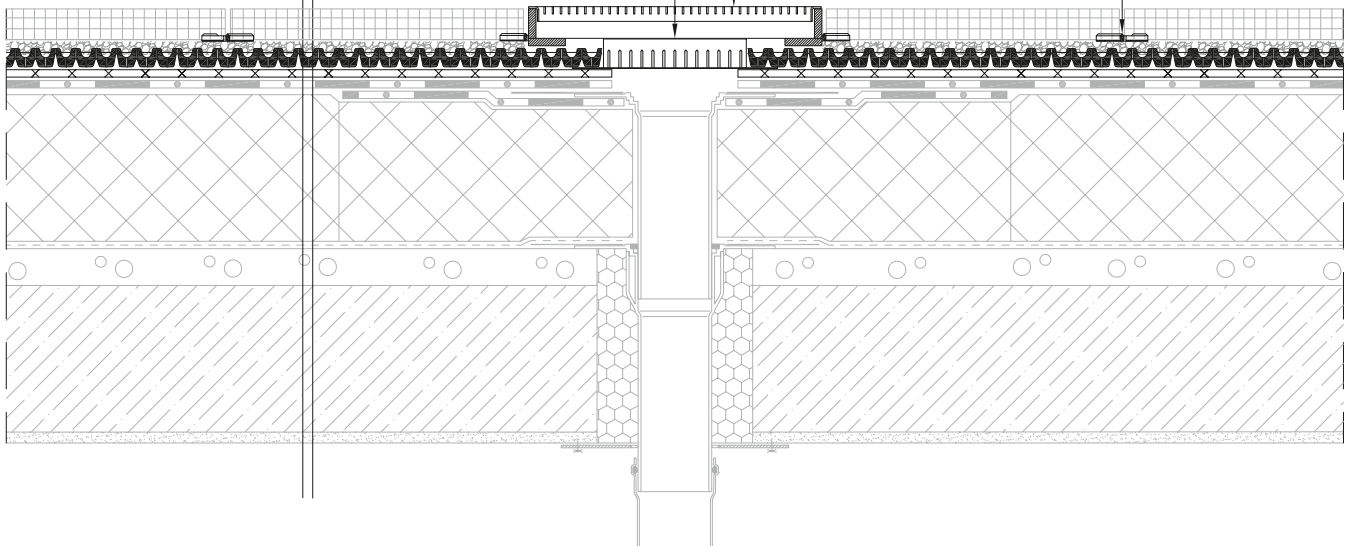

0 10 50 cm